



PERSONAL CARE

2024 PERSONAL CARE RATES	DAILY FEE
Studio - Homestead North & South	\$225
Studio - Homestead Main	\$265
Suite - Homestead North & South	\$310
Garden View Memory Support	\$315
Level II Care (in excess of 1 hour of care/day)	add \$90/day
Second Person	add \$110/day

INCLUDED IN THE DAILY RATE

Assistance with Activities of Daily Living:

- Medication administration
- Bathing (1/week) - including spa bath with soothing music & warming elements
- Personal Hygiene
- Dressing
- Walking
- Managing health care & appointments
- Managing finances
- Securing transportation
- Written & telephone communication
- Caring for personal possessions
- Using prostheses (commonly dentures or hearing aids)
- Engaging in activities

Select Health Care Services

- 24/7 nurse availability
- Family & resident involvement in care planning
- Monitoring of physical & emotional health
- Insurance filings
- Priority access to skilled care households, if needed

Services & Products that Enhance Daily Life

- 24/7 emergency response system
- Three meals per day
- Laundering of supplied linens
- Housekeeping of rooms & common spaces
- Clothing labeling
- Maintenance of rooms, buildings, & grounds
- Utilities
- Trash removal

Activities Programming

- Daily schedule of social & recreational activities
- Sunroom for games, socials, crafts, & more
- Local trips
- Library
- Chaplain services, including devotions & worship services
- Common lounges & living rooms for gathering
- Televisions, telephones, Wi-Fi, and puzzles in common areas

PERSONAL CARE FLOOR PLANS

INCLUDED WITH EACH ACCOMMODATION:

- All private accommodations
- All private bathrooms
- Individual temperature control
- Walk-in shower with shower seat & grab bars
- Comfort-height toilet
- Bed & bath linens, including pillow
- Soap & toiletries
- Compact refrigerator, if desired
- Basic furnishings, if desired

FOR AN ADDITIONAL FEE, YOU MAY ADD:

- Cable TV - \$32/mo.
- Internet - \$23/mo.
- Home care - \$32/hour
- Personal laundry - \$45/mo.
- Telephone service - \$22/mo.
- Personal transportation - \$5.50/mile



Sample Studio
in Homestead North & South
in Garden View Memory Support

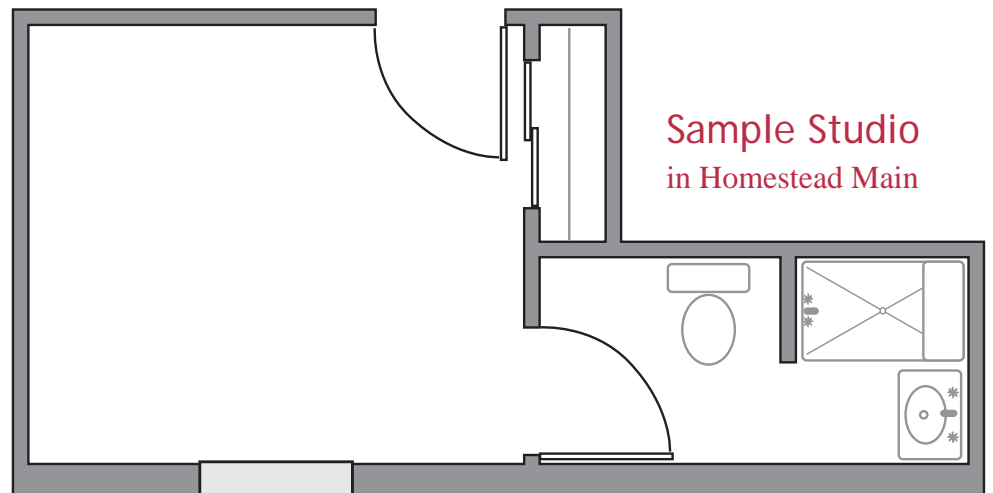
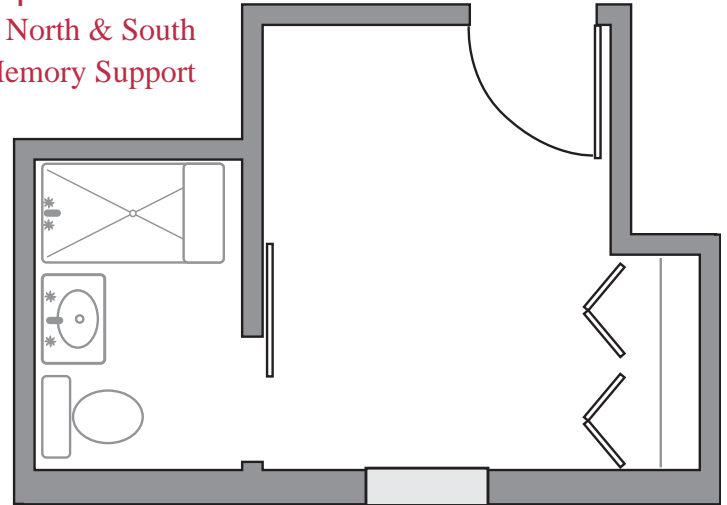

Sample Studio
in Homestead Main

Sample Suite
in Homestead North & South

